

ALL STEAMED UP

17 & 18 NOVEMBER 2018



Shuttle Bus Circuit (to Mannum Football Club Oval car parking facility)

North Terrace Oval - Johnson Hill - River Lane - Wattle Street - Randell Street



SHUTTLE BUS MEETING POINT



ROUTE

TOWN CENTRE

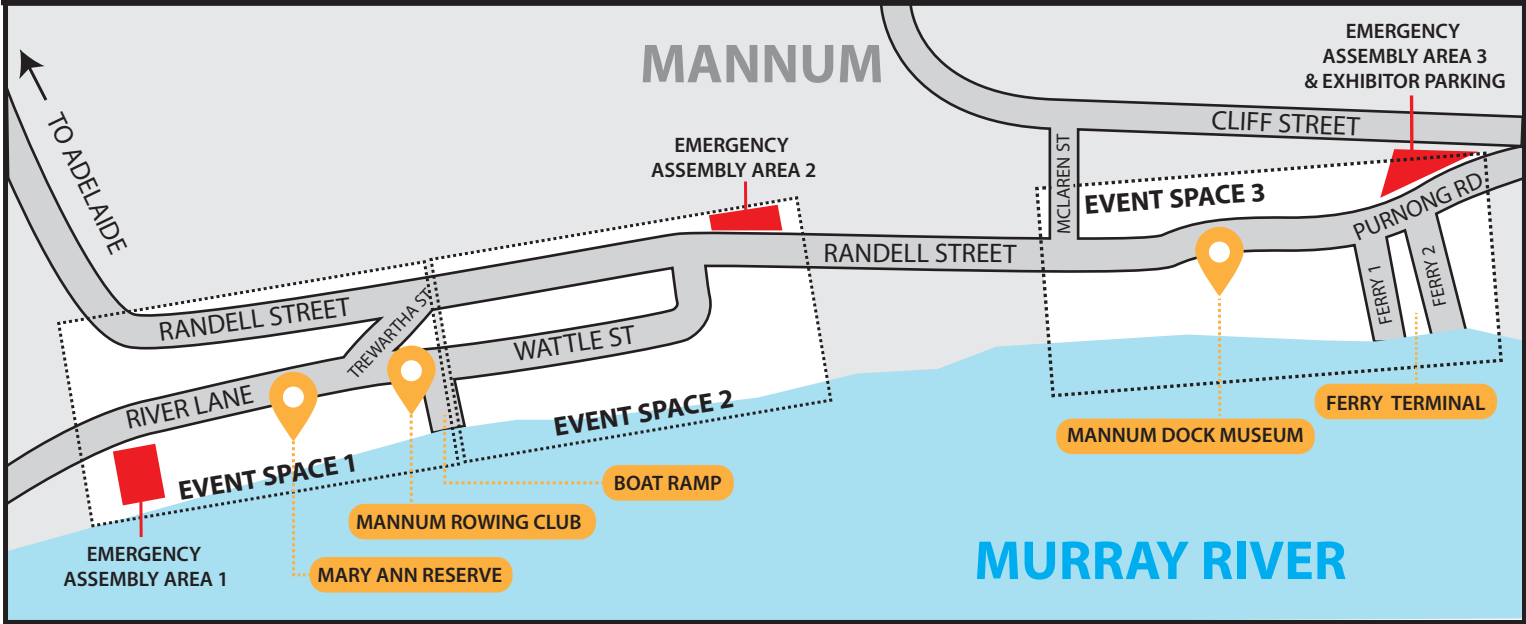

EVENT SPACE 1 - MARY ANN RESERVE (SOUTHERN END)

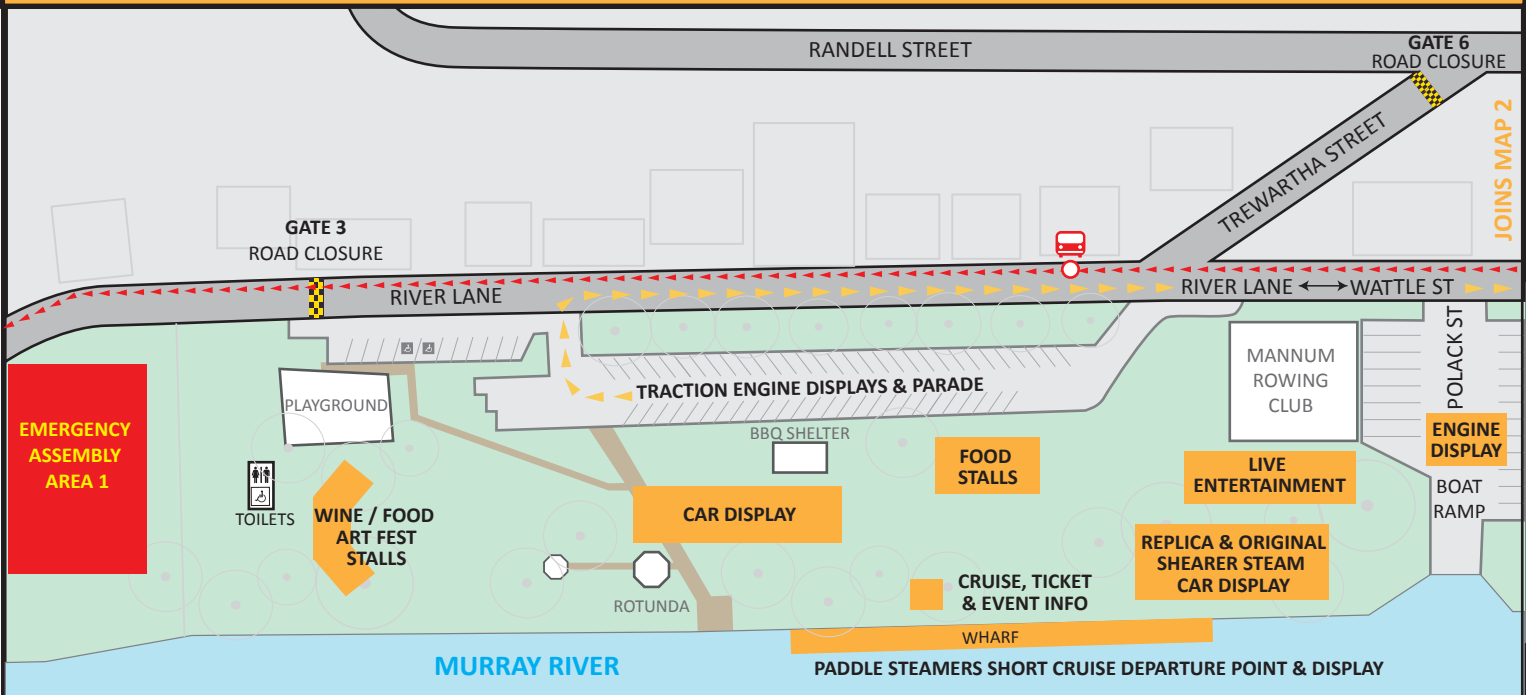

EVENT SPACE 2 - MARY ANN RESERVE (NORTHERN END)

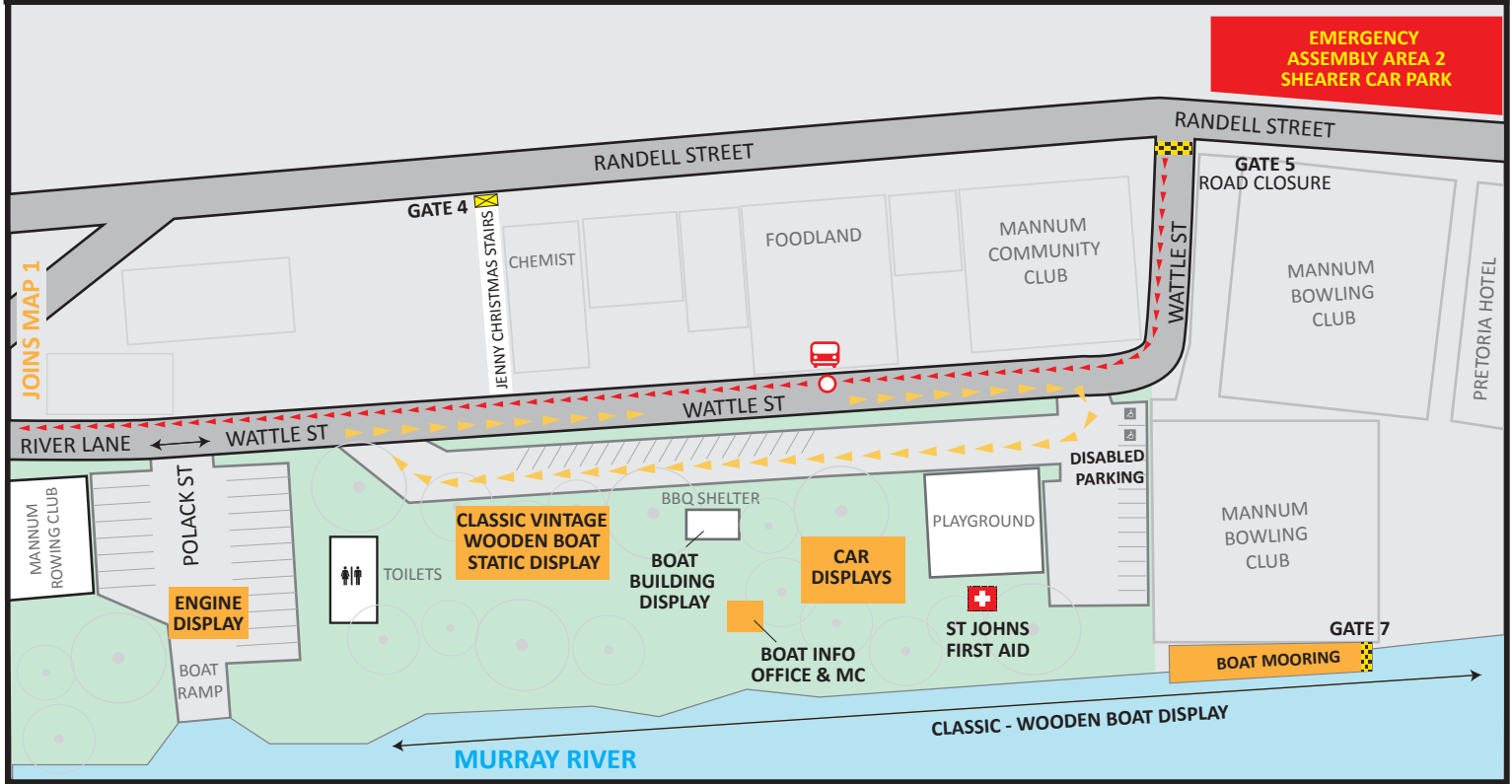

EVENT SPACE 3 - MANNUM DOCK MUSEUM & ARNOLD PARK

